

Project Name

arkenea

Functional Specifications

Project Name

Document History

<u>Version</u>	<u>Date</u>	<u>Release Note</u>	<u>Author</u>
1.0	DD-MON-YYYY	This is a sample FS document from Arkenea Technologies	Ritika Jangid, Arkenea

Table of Contents

Overview	4
1. Introduction.....	4
2. Platform.....	4
Application	5
3. Get Started	5
4. Sign Up with Email.....	6
5. Log In	7
6. Forgot Password.....	8
Assumptions	9
Out of Scope	10

Project Name

Overview

1. Introduction

This section describes the application and target users.

2. Platform

Application

1. Supported
 - 1.1. iOS (iPhone & iPad) – OS 8.0 and above
 - 1.2. Android (mobile & tablet) – OS 4.1 and above
2. Orientation: Portrait

Web Interface

- Supported browsers: IE 9+ , FireFox 11+, Chrome 18+, Safari 5.1+

Application

This section describes each of the application feature along with the workflow. The behavior of each component from the wireframe is detailed.

3. Get Started

Screen 1 Get Started

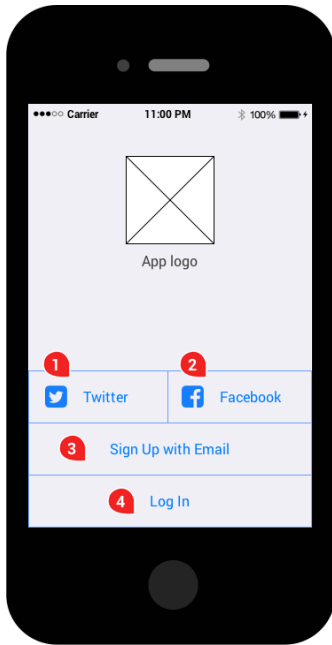

Get Started: On application start, this is the first screen that is displayed in the user had not logged in to the application. User needs to log in or sign up to access the application.

Sr. No	Label	Data Type	Validation / Workflow
1	Twitter	Button	Users can connect with the application through their Twitter account. After permission, the application will pull relevant data from Twitter for use within the application like user name.
2	Facebook	Button	Users can connect with the application through their Facebook account. After permission, the application will pull relevant data from Facebook for use within the application like user name.
3	Sign up with email	Button	On tap, the sign up form section is opened in the same screen and if the log in form section was opened, it is closed. Refer: Sign Up with Email
4	Login	Button	On tap, the log in form section is opened in the same screen and if the sign up form section was opened, it is closed. Refer: Log In

4. Sign Up with Email

Screen 2 Sign Up with Email

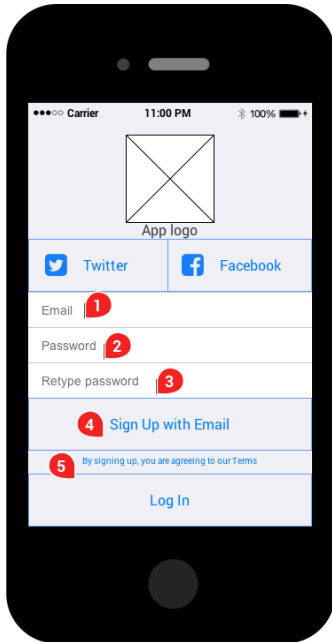

Sign up with Email: User can create a new account with their email.			
Sr. No	Input	Data Type	Validation / Workflow
1	Email	Input, Text box	The email address user wants to create an account with. Mandatory, should follow standard email format.
2	Password	Input, Password text box	Mandatory. The password entered should be minimum 6 characters and a mix of alphanumeric characters.
3	Retype password	Input, Password text box	Mandatory, should match the value entered in 'Password' field.
4	Sign up with Email	Button	The server will validate the email for uniqueness. If validated, users' details are updated and he/she is successfully logged in to the application. (Refer: Section name) If not validated, the application will display error message "Email already registered. Log In to access your account."
5	Terms & Conditions	Text link	Option to view terms and conditions in a web view within the application – it is considered implicit that the user agrees to the terms and conditions by signing up.

5. Log In

Screen 3 Log In

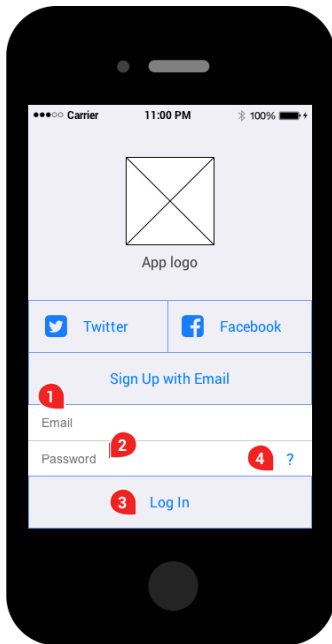

Log In: User can log in to their account via their registered email.			
Sr. No	Label	Data Type	Validation / Workflow
1	Email	Input, Text box	Mandatory
2	Password	Input, Password text box	Mandatory
3	Log In	Button	The server will verify the email & password and match with credentials of registered users. If verified, users' details are updated and he/she is successfully logged in to the application. (Refer: Section name) If not verified, the application will display error message "Incorrect email or password. Please try again."
4	Forgot Password	Button	User can request to reset their password. Refer: Forgot Password

6. Forgot Password

Screen 4 Forgot Password

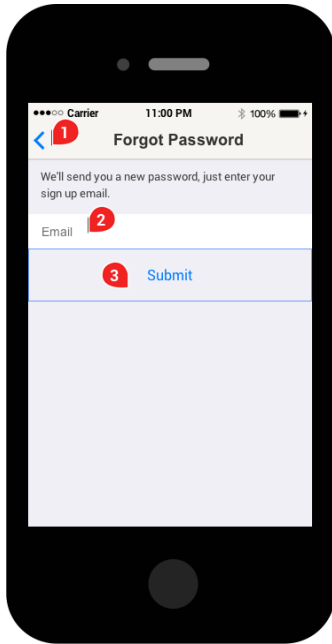

Forgot Password: User can generate a new password. New password is sent to user via email on their registered email address.			
Sr. No	Label	Data Type	Validation / Workflow
1	Back	Button	Go to previous screen. Refer Log In
2	Email	Input, Text box	Mandatory
3	Submit	Button	The server will verify the email to check if it is a registered email. If verified, the system sends a new password to the user via email and displays message "A new password is sent to your registered email" with option Ok. On tap Ok, display Log In screen. If not verified, the application will display error message "You are not registered. Please sign up to create a new account."

Project Name

Assumptions

This section lists the assumptions taken for the project (if separate from the feature definition).

Project Name

Out of Scope

This section lists all out of scope features.